

FAZA I: LUCRARI PREGATITOARE:

- Se amenajeaza drumurile de acces si platformele tehnologice.
- Se realizeaza organizarea de santier.
- Se umpluseaza din aval 3 conducte metalice $\phi 1000$, L=80m. Acestea vor avea la capete diguri din argila bine compactata.

STAGE I: PRELIMINARY WORKS

- Arranging the access roads and the technological platforms.
- Making the site organization.
- Providing from downstream 3 metallic pipes $\phi 1000$, L=80m. They will be provided at the ends with well compacted clay dykes.

FAZA II: REALIZAREA INFRASTRUCTURII:

- Se executa incintele de palplance.
- Se executa sapaturile in interiorul incintelor iar odata cu avansarea acestora se vor monta spraturile.
- Se executa betonul de egalizare iar dupa atingerea clasei se demonteaza spraturile de la partea inferioara.
- Se monteaza cofrajele pentru fundatii, si se executa fundatiile infrastructurilor.
- Dupa atingerea a 80% din clasa betonului din fundatii, acestea se decoafeaza, se scoot spirintele si se executa umplutura din jurul lor.
- Se monteaza cofrajele pentru banchetele infrastructurilor si pentru zidurile intorse ale culeei si se betoneaza.
- Dupa atingerea clasei betonului din banchete si din zidurile intorse se decoafeaza.
- Se executa hidroizolatia pe spatele culeilor.
- Se executa umplutura din balast stabilizat cu ciment la cota.
- Se executa fundatia drenului conform detaliilor din proiect.
- Se executa sistemul drenant (geodren, geotextil si tub).
- Se monteaza paletele provizorii.

STAGE II: EXECUTION OF THE INFRASTRUCTURES

- Making the sheet-pile premises.
- Making the excavations inside the premises and mounting spurs as the excavations progress.
- Making the levelling concrete and dismantling the spurs from the lower part after reaching the class.
- Mounting the formwork for foundations and making the infrastructures' foundations.
- Removing the formwork of the foundations after reaching 80% of the class of concrete in foundations, dismantling the spurs and executing the filling around foundations.
- Mounting the formwork for elevations and making the infrastructures' elevations.
- Mounting the formwork for the infrastructures' benches and for the wing walls of the abutment and casting the concrete.
- Removing the formwork after reaching the class of concrete in the benches and in the wing walls.
- Making the waterproofing on the back side of the abutments.
- Making the filling out of ballast stabilizer with cement at level.
- Making the drain foundation according to the details in the design.
- Making the draining system (geo-drain, geo-textile and tube).
- Mounting the temporary bents.

FAZA II: REALIZARE INFRASTRUCTURI
STAGE II: MAKING THE INFRASTRUCTURES

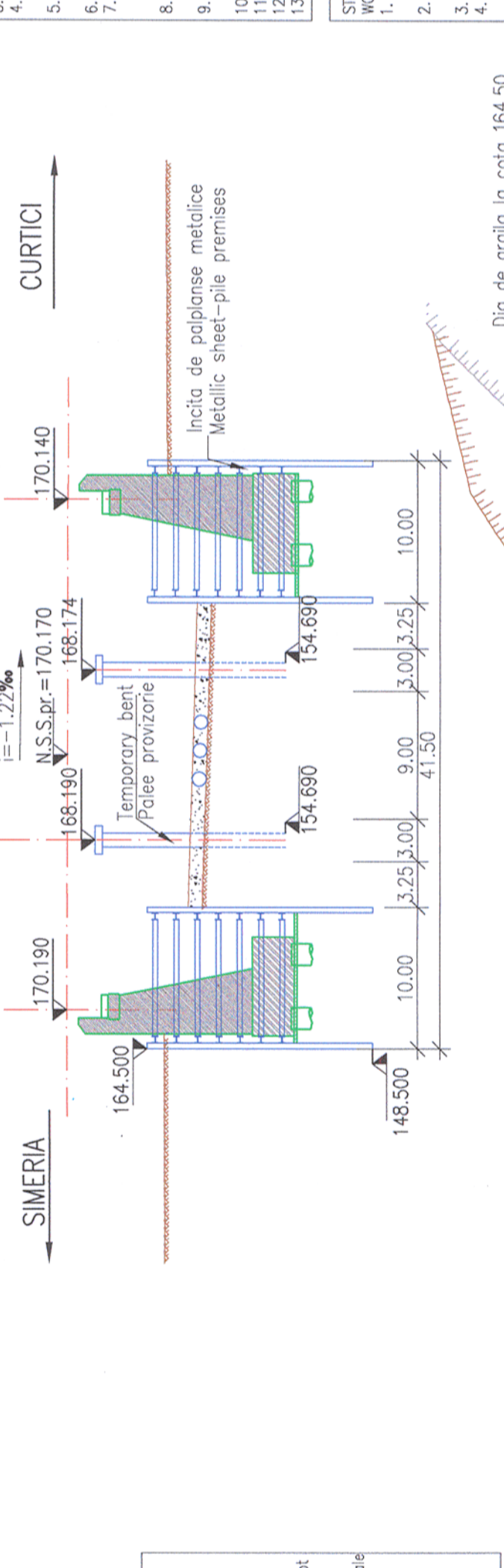

SECTIUNE TRANSVERSALA PALEE
TEMPORARY BENT CROSS-SECTION

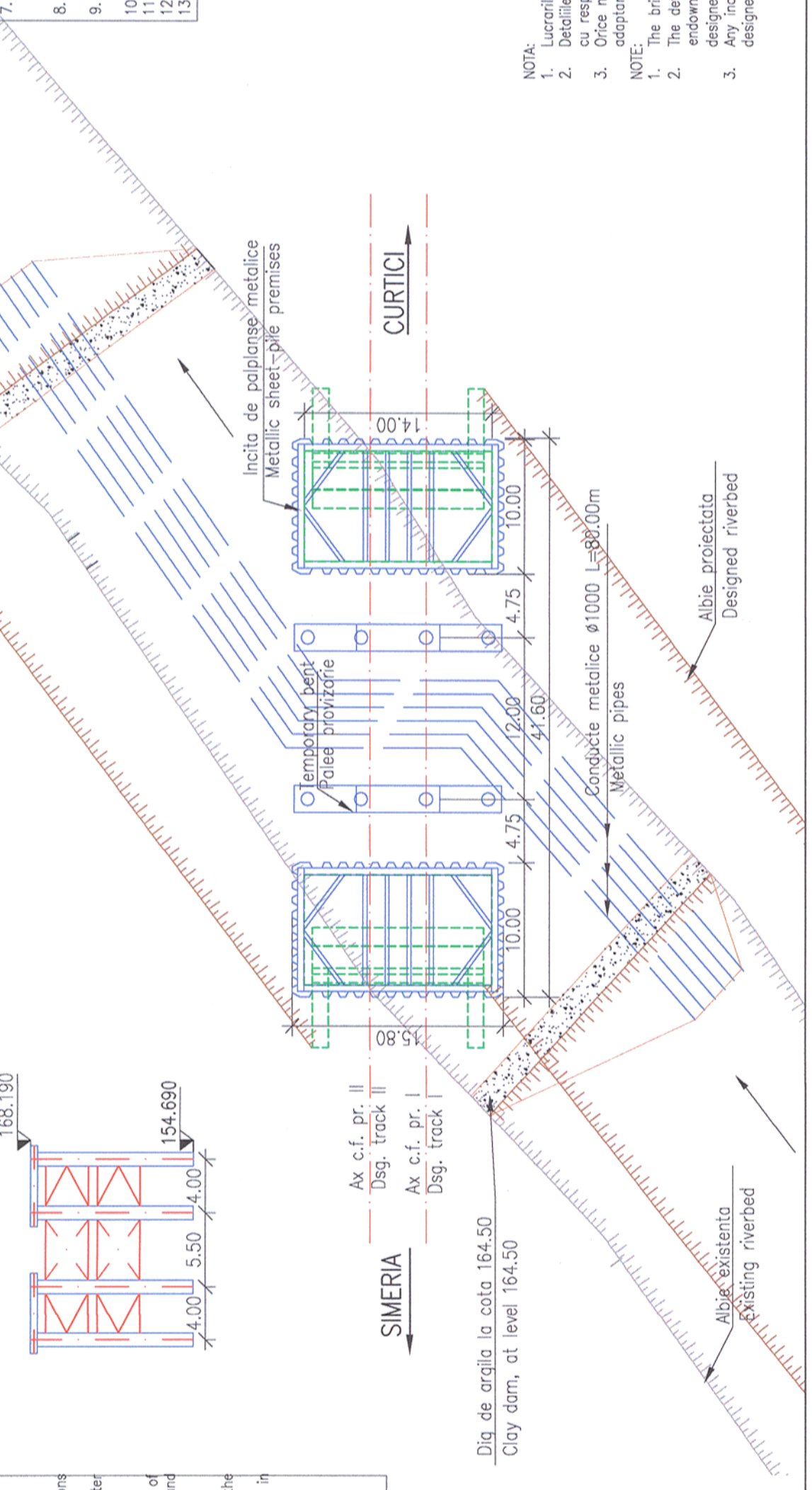

- FAZA III: EXECUTIE SUPRASTRUCTURA SI LUCRARI DE ALBIE**
- Se monteaza paletele inferioare, antritoazele, barele grinzilor principale.
 - Se monteaza platielajul metalic, cu exceptia zonelor in care se afla paletele provizorii.
 - Se pozitioneaza tablierii metalici pe aparatele de rezem. Se asigura paletele inferioare, antritoazele, barele grinzilor principale.
 - Se pozitioneaza paletele inferioare, antritoazele, barele grinzilor principale.
 - Se monteaza platielajul metalic in zonele libere, opritorii de balast si consolele de trotuar.
 - Se executa terasamentul si racordurile cu terasamentul.
 - Se executa calea pe pod si se racordeaza la capete asigurand racordarea in plan vertical si orizontal, cu linia proiectata.
 - Se asigura continuitatea circulatoriilor de cale si se asigura protectia electrica.
 - Se pune sub tensiune linia de contact, si se deschide circulatia in trepte de viteza pe traseul proiectat.
 - Se scoot conductele metalice din albie.
 - Se executa drumul din jurul culeii Curtici.
 - Se executa lucrarile de protectie si profilare a albiei.
 - Se dezafecteaza organizarea de santier.

- STAGE III: EXECUTION OF THE SUPERSTRUCTURE AND RIVERBED WORKS**
- Mounting the lower flanges, the cross-bar pieces, the bars of main girders.
 - Mounting the metallic bridge planks, except for the areas where there are temporary bents.
 - Placing the metallic deck on the bearing devices.
 - Removing the temporary bents, through the open spaces left in the bridge planks.
 - Mounting the metallic bridge planks in the open areas, the ballast buffers and the sidewalk cantilevers.
 - Making the embankment and the connection to the embankment.
 - Making the track on the bridge and connecting at the ends ensuring the connection in vertical and horizontal plan with the track on embankment.
 - Ensuring the continuity of the track circuits and the electric protection.
 - Restoring the voltage to the contact line and opening the traffic in speed levels on the designed route.
 - Removing the metallic pipes from the riverbed.
 - Making the road around Curtici abutment.
 - Making the riverbed protection and shaping works.
 - Dismantling the site organization.

DESCHIDEREA CIRCULATIEI FEROVIARE PE PODURILE PROVIZORII SE VA FACE ASTFEL:

- In primele 24h se ridica viteza in trepte de 5km/h, se tine sub observatie permanenta si se rectifica niveleta si tasarile aparute in exploatare; pe durata exploatarii podului provizoriu in care aceasta se tine sub observatie permanenta, iar eventualele deficiente aparute se remediaza imediat.
- dupa 24h de la data in exploatare a podului provizoriu se va circula cu restrictie de viteza de 30 km/h.

THE OPENING OF THE TRAFFIC ON THE TEMPORARY BRIDGES WILL BE CARRIED AS FOLLOWING:

- in the first 24 hours the speed is raised in stages of 5 km/h, the level is permanently kept under surveillance and there are rectified the level and settlements that occur during the operations.
- after 24 hours since the temporary bridge is in operation the traffic will be under speed restriction of 30 km/h;

NOTE:

- Lucrarile la pod vor fi executate obligatoriu inainte de lucrari la linie.
- Detaliile prezentate in acest plan nu sunt obligatorii si pot fi modificate sau adaptate in functie de datele constructorului cu respectarea conditiilor de realizare a lucrarilor definitive prevazute in culetele de sarcini si cu acordul proiectantului.
- Orice neconcordanza intre elementele ovute in vedere la elaborarea proiectului si teren va fi anuntata proiectantului pentru adaptare la situatia existenta.

NOTE:

- The bridge works will be carried-out obligatorily before the line works.
- The details presented in this plan are not compulsory and can be modified or adapted depending on the constructor's endorsements by observing the execution conditions of the final works provided in the Technical Specifications and the designer's approval.
- Any incongruity between the elements taken into account when preparing the design and the site will be announced to the designer so that he can adapt to the existing situation.

<p>Prezentul plan anuleaza si inlocuieste versiunea anterioara This plan cancels and replaces previous version</p>							
Verificator / Expert Checker / Expert	Cerinta Requirement	Semnatura Signature	Referat / Expertiza Report / Expertise				
PROIECTANT / DESIGNER: 		Data Date		Semnatura Signature			
Aprobat Approved	Sef de echipa Team leader	Data Date		Semnatura Signature			
Verificat Checked	Expert Cheie Key Expert	Data Date		Semnatura Signature			
Subcontractant / Subcontractor 		Data Date		Semnatura Signature			
Aprobat Approved	Adjunct Sef de echipa Deputy Team leader	Data Date		Semnatura Signature			
Proiectat Designed	Inginer Engineer	Data Date		Semnatura Signature			
"Reabilitarea liniei c.f. Frontieră - Curtici - Simeria, parte componentă a coridorului IV Pan - European pentru circulația trenurilor cu viteză maximă de 160 km/h" Tronsoanel 2-C : cap Y Ilteu - cap Y Gurasada		Data Date		Semnatura Signature			
"Rehabilitation of the Railway Line Border - Curtici - Simeria, component Part of the IV Pan - European Corridor for the Trains Circulation with maximum speed of 160 km/h" Section 2-C : end Y Ilteu - end Y Gurasada		Data Date		Semnatura Signature			
Denumire desen / Drawing name: TEHNOLOGIE DE EXECUTIE/TECHNOLOGICAL PROCESS POD /BRIDGE KM pr.518+905		Data Date		Semnatura Signature			
Scara / Scale 1:500 1:200	Revizia / Revision 1 / 04.2013	Cod desen / Drawing Code PT.02.02.17.PO.05.04		Nr / No 04			

